

DL-6350 Product Brief

USB to Dual WQHD/WQXGA with Gigabit Ethernet Dock SoC

From the world leader in USB graphics, Synaptics introduces the new DL-6350 Dock system-on-chip (SoC) that enables multiple 60 Hz low latency 2560x1600 resolution monitors over standard USB3.1Gen1 Type-C® and Standard-A connectors. The DL-6350 is highly integrated with included 1Gb Ethernet LAN, 5.1 Audio, DisplayPort 1.2 and HDMI® 1.4. The DL-6350 couples with DisplayLink® software on the host PC or mobile device, requiring zero hardware cost on the host. Since the DL-6350 is a pure USB solution, it can connect to any host with Standard A or Type-C connectors, providing a fully backward-compatible and future-proof docking solution. Plug it in and it works with no USB ALT Mode confusion.

DL-6350 Target Products

- Dual FHD/WQHD/WQXGA adapters
- USB docking

Maximum Resolution

- 2560 x 1600 @ 60 Hz

Product Applications

- USB3.1 Gen2/Gen1 Universal Docks
- USB3.1 Gen2/Gen1 Monitor Docks

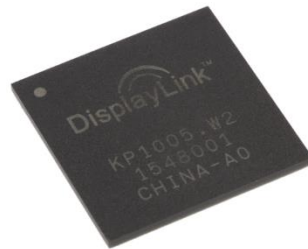

Benefits

- Single USB connector to support up to dual WQXGA
- Compatible with USB2 or USB3.1 Gen2/Gen1 Standard A or Type-C connections
- Multiple WQXGA displays on legacy PCs
- Integrated Ethernet and Audio
- 100% compatible with existing DisplayLink universal docking

Features

- 60 Hz panel refresh for lowest latency
- 2x 2560 x 1600p60 - WQXGA
- 2x 2560 x 1440p60 - WQHD
- 2x 1920 x 1080p60 - FHD
- Backward compatible with legacy monitors
- Integrated DP 1.2/DP++ interfaces
- Integrated HDMI 1.4 interfaces
- HDCP for protected video playback
- Integrated Gigabit Ethernet
- USB 3.1 Gen 1
- Integrated 2.0 Audio and 5.1 Audio

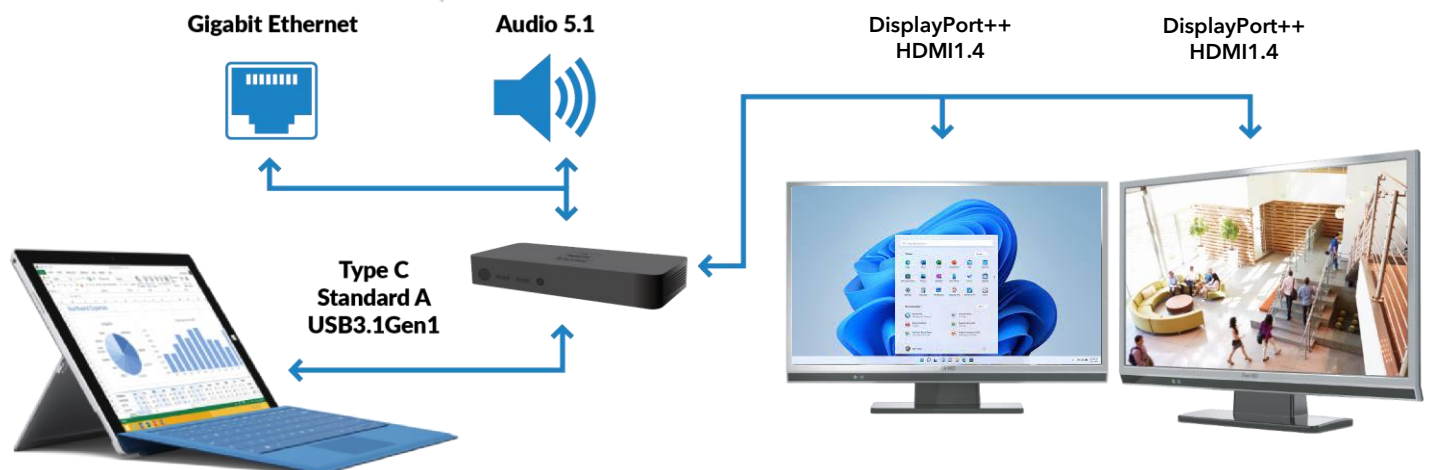

DL-6350 Product Brief

USB to Dual WQHD/WQXGA with Gigabit Ethernet Dock SoC

USB Type-C: DL-6350 Supplies the Most Display Capacity

USB Type-C™ connector works seamlessly with DisplayLink USB graphics and docking. Whatever the host GPU capability, the DL-6350 enables up to two 2560x1600p60 displays without the added complexity of Alternate Modes that other standards such as VESA and MHL impose on the connector.

Because only a simple driver is required, the DL-6350 also works over any USB interface such as Standard-A, Micro-A or Type-C, as well as other non-PC platforms such as Mac®, Chrome™ OS, Ubuntu®, or Android™. The DL-6350 can also be extended by daisy-chaining other devices with DisplayLink technology.

SKU Options

SKU	Application
DL-6350	Two Head 2.5K Dock Chip with HDCP enabled (Requires DCP License) 484 BGA (18 x 18 x 1.2 mm)
DL-6350-N	Two Head 2.5K Dock Chip without HDCP enabled 484 BGA (18 x 18 x 1.2 mm)

2.5K USB Universal Docking

Based on the industry leading DL3 compression technology DL-6350 extends the benefits of low latency pixel perfect graphics to high-resolution monitors.

The DL-6350 integrates a USB 3.1 Gen 1 device interface, DL3 codec, two DisplayPort++ (dual mode) interfaces, two HDMI 1.4 interfaces, GbE, and audio on one SoC. The DL-6350 is supported by DisplayLink software for zero cost on the host for seamless docking on all hosts.

The DL-6350 also offers enhanced performance capabilities compared to the previous generation:

- 60 Hz panel refresh
- GPU/CPU balancing**
- Hardware accelerated mouse cursor**
- Heal to Perfect**

Assured compatibility between Type-C and Legacy USB:

Host	Dock	
	Standard-B Legacy Dock	Type-C New Dock
Standard-A Legacy Host	Just works	Just works
Type-C New Host	Just works	Just works

DL-6350 Video Output Options

The DL-6350 has four display outputs, two DP++ (dual mode DP 1.2) and two HDMI 1.4 interfaces integrated into the device. Only two outputs are active at any time.

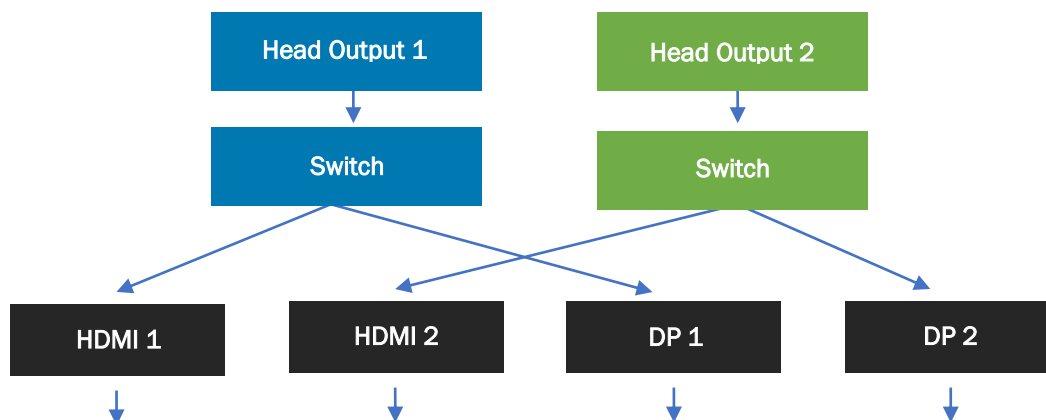

DL-6350 Product Brief

USB to Dual WQHD/WQXGA with Gigabit Ethernet Dock SoC

DisplayLink Certified Plug and Display

DisplayLink Certified products are thoroughly tested in our labs to guarantee interoperability with the vast DisplayLink graphics ecosystem. Regular software updates ensure a lifetime of performance enhancements.

Look for the DisplayLink Certified Plug and Display mark.



DisplayLink Compression – DL3

- Low latency
- Pixel-perfect graphics
- Adapts automatically to bandwidth constraints
- Compression tuned for video content and high-quality graphics
- Uncompromised FHD/WQHD/WQXGA video quality

DL-6350 Monitor Support			
Interface	WQXGA	WQHD	FHD
	2560 x 1600p60	2560 x 1440p60	1920 x 1080p60
DP1	✓	✓	✓
DP2	✓	✓	✓
HDMI1	✓	✓	✓
HDMI2	✓	✓	✓

Supported Platforms

- Microsoft Windows® 10/11
- Apple Mac® OS
- Google® Android™
- Chrome OS™
- Linux™ Ubuntu®



WQXGA/QHD
HDCP

Trademarks

DisplayLink, Synaptics and the Synaptics logo are trademarks or registered trademarks of Synaptics Incorporated or its affiliates in the United States and/or other countries.

Apple and Mac are trademarks or registered trademarks of Apple Inc., registered in the U.S. and other countries. Android and Google are trademarks or registered trademarks of Google LLC. HDMI logo are trademarks or registered trademarks of HDMI Licensing Administrator, Inc. Ubuntu and Linux are trademarks or registered trademarks of Linus Torvalds in the U.S. and other countries. USB Type-C is a trademark of the USB Implementers Forum. Windows and Microsoft are registered trademarks of the Microsoft Corporation in the United States and/or other countries. All other marks are the property of their respective owners.

Notice

Use of the materials may require a license of intellectual property from a third party or from Synaptics. This document conveys no express or implied licenses to any intellectual property rights belonging to Synaptics or any other party. Synaptics may, from time to time and at its sole option, update the information contained in this document without notice.

INFORMATION CONTAINED IN THIS DOCUMENT IS PROVIDED "AS-IS," WITH NO EXPRESS OR IMPLIED WARRANTIES, INCLUDING ANY IMPLIED WARRANTIES OF MERCHANTABILITY AND FITNESS FOR A PARTICULAR PURPOSE, AND ANY WARRANTIES OF NON-INFRINGEMENT OF ANY INTELLECTUAL PROPERTY RIGHTS. IN NO EVENT SHALL SYNAPTICS BE LIABLE FOR ANY DIRECT, INDIRECT, INCIDENTAL, SPECIAL, PUNITIVE, OR CONSEQUENTIAL DAMAGES ARISING OUT OF OR IN CONNECTION WITH THE USE OF THE INFORMATION CONTAINED IN THIS DOCUMENT, HOWEVER CAUSED AND BASED ON ANY THEORY OF LIABILITY, WHETHER IN AN ACTION OF CONTRACT, NEGLIGENCE OR OTHER TORTIOUS ACTION, AND EVEN IF SYNAPTICS WAS ADVISED OF THE POSSIBILITY OF SUCH DAMAGE. IF A TRIBUNAL OF COMPETENT JURISDICTION DOES NOT PERMIT THE DISCLAIMER OF DIRECT DAMAGES OR ANY OTHER DAMAGES, SYNAPTICS' TOTAL CUMULATIVE LIABILITY TO ANY PARTY SHALL NOT EXCEED ONE HUNDRED U.S. DOLLARS.